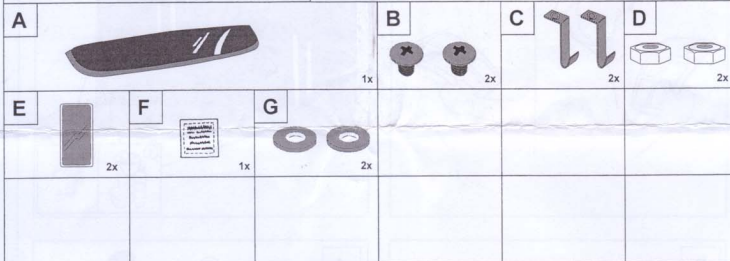

**SUBARU** INSTALLATION  
INSTRUCTIONS

PART NUMBER:

DESCRIPTION: MOONROOF AIR DEFLECTOR

VEHICLE DESCRIPTION: SUBARU FORESTER 09

**Tools Required**

Phillips head screwdriver

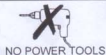
**Meaning of Characters:**

:Remove

T

:Tightening Torque



:Install



:Loosen



:Disconnect



:Connect



:Discard



:Location of Clips or Screws



:Re - use

**IMPORTANT NOTES**

- DO NOT USE SOLVENT BASED CLEANERS ON MOONROOF AIR DEFLECTOR.
- DO NOT USE LOCTITE ON DEFLECTOR ATTACHING SCREWS.
- USE SOAP AND WATER ONLY TO CLEAN MOONROOF AIR DEFLECTOR.

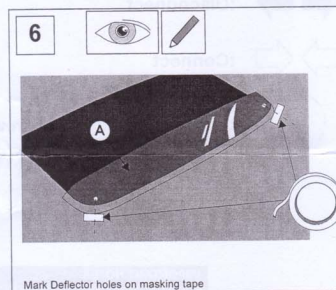
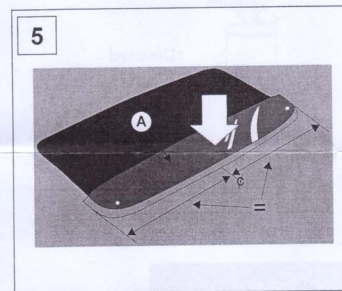
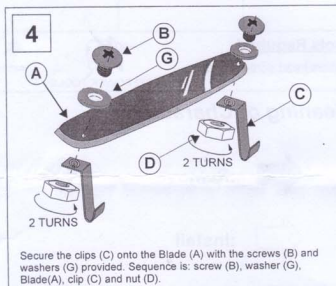
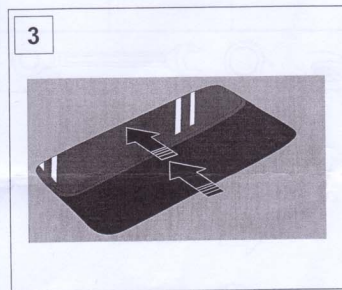
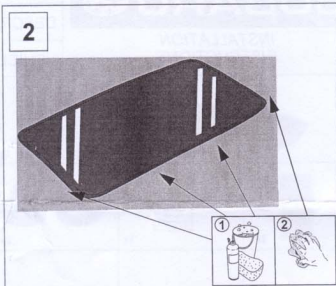
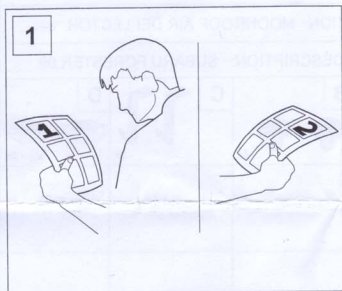

7

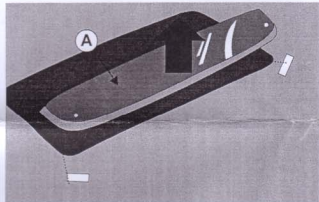

8

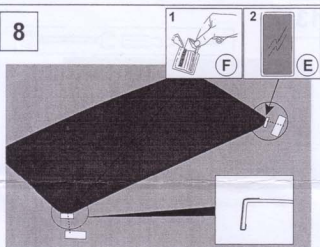

Clean areas shown using provided wipe (F) dry with a clean cloth then install tape (E) to clean areas.

9

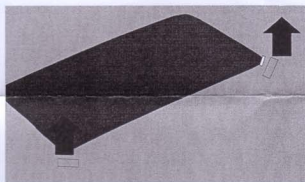

10

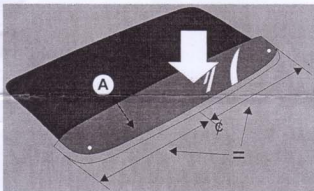

11

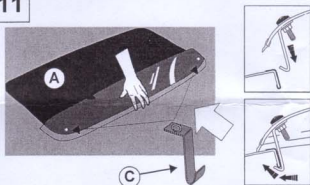

Push down gently on Deflector (A) so clips (C) hook under Moonroof sheet metal flange.

12

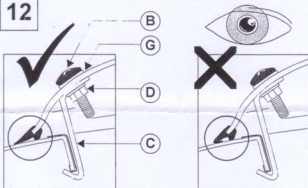

Before tightening, ensure the rubber seal is flat against the roof and not curling under itself.

13

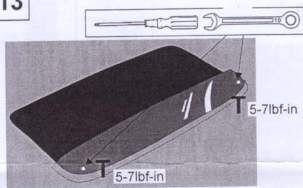

Tighten screws and nuts to secure Deflector to roof.

